

DOYON UTILITIES USSA SUPER TOUR FINALS/ DISTANCE NATIONAL CHAMPIONSHIPS

Team Captains' Meeting #1



ROLL CALL



- „ Alaska Nordic Racing – Cody Priest
- „ Alaska Pacific University NSC – Erik Flora
- „ Alaska Winter Stars – Jan Buron
- „ Bend Endurance Academy – Bernie Nelson
- „ Bridger Ski Foundation – Dragan Danevski
- „ Craftsbury Green RP – Pepa Miloucheva
- „ CXC – Andy Keller
- „ Loppet Nordic Racing – Chris Harvey
- „ NSC Fairbanks/FXC – Pete Leonard
- „ Northern Michigan University – Sten Fjeldheim
- „ Ski and Snowboard Club Vail – Evan Elliott
- „ Stratton Mountain School/T2 – Pat O’Brien
- „ Sun Valley SEF Gold – Chris Mallory
- „ UA Anchorage – Andrew Kastning
- „ UA Fairbanks – Nick Crawford

WELCOME



The Nordic Ski Club of Fairbanks
Welcomes you to Alaska, Fairbanks
and Birch Hill.

Thank you for traveling to our
community. We hope you enjoy your
stay.

Our volunteers have been looking
forward to this event all season.

We have had a very snowy winter (for
us). Our courses are in good shape
and ready for the races.

If you have the time, we hope you will
ski some of the other courses at Birch
Hill and get a real feel for the facility.

Enjoy!

COMPETITION JURY



- „ Technical Delegate – Allan Serrano
- „ Assistant Technical Delegate – Jeff Ellis
- „ USSA Representative – Bryan Fish / Robert Lazzaroni
- „ Chief of Competition – John Estle
- „ Jury Member – Lin Hinderman

COMPETITION COMMITTEE



- „ Chief of Competition – John Estle
- „ Asst Chief of Competition for Course & Stadium – Greg Whisenhant
- „ Asst Chief of Competition for Timing, Secretariat and IT – Scott Jerome
- „ Chief of Course – Bill Husby
- „ Chief of Course Control – Van Mitchell
- „ Chief of Stadium – Susan Faulkner
- „ Chief of Timing – Anna Sorensen
- „ Timing Contractor – Ernie Page
- „ Chief of Secretariat – Beth Zirbes

WEATHER FORECAST

National Weather Service
Forecaster

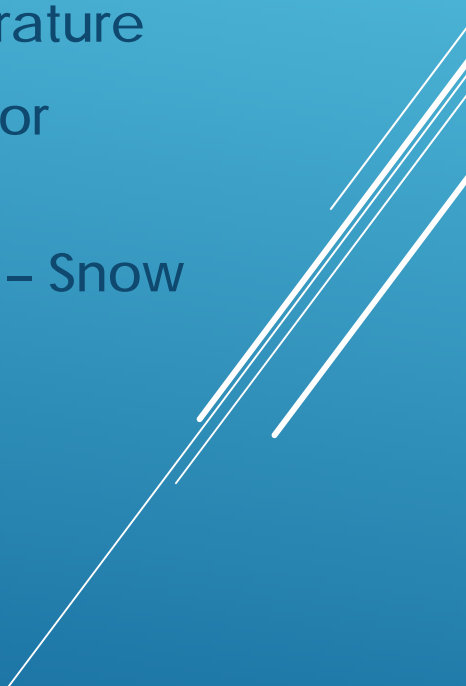
- „ Today's High Temperature
 - „ Overnight Low
 - „ Tomorrow's High Temperature
 - „ Tomorrow's Skies (clear or cloudy)
 - „ Chance of Precipitation – Snow or Rain
- 
- A decorative graphic consisting of several parallel white lines of varying lengths, slanted diagonally from the bottom right towards the top right, located in the lower right quadrant of the slide.



NOAA's National Weather Service Fairbanks

Prepared: 9:30 AM - Sunday Mar 26, 2017

VALID: Sun Mar 26th – Mon Mar 27th

<http://www.weather.gov/fairbanks>

 /NWSFairbanks



/US.NationalWeatherService.Alaska.gov

 @ NWSFairbanks



Weather Safety Briefing: Distance National Championship 2017



„ *Weather Hazards (Watches, Warnings, Advisories):*

NONE!

„ *Weather Overview:*

Pattern Change: High pressure giving way to a series of weak low pressure systems moving north from the Gulf of Alaska this week. Some timing uncertainty with each wave, but expecting low chances of snowfall with any accumulations ≤ 1 ". Southerly flow brings warmer air mass with high temperatures climbing above freezing by Friday.

For Weather Updates: weather.gov/fairbanks



/NWSFairbanks



/US.NationalWeatherService.Alaska.gov

@ NWSFairbanks

Issued: 03/26/2017 9:30 AM



Weather Safety Briefing: Distance National Championship 2017



Birch Hill Recreation Area - Stadium

SUN NIGHT

Sky Condition: Partly cloudy.

Weather: None.

Overnight Low Temp: 6F at 8 AM

Max RH: 75%

Wind: NE 3-5 mph.

Inversion: Moderate to strong. Expected to break around 10 AM.

MONDAY/MONDAY EVE

Sky Condition: Partly cloudy becoming mostly cloudy in the afternoon.

Weather: Flurries.

- Likelihood: 40 %
- Time of day: 3 PM and beyond.

Daytime High Temp: 26F at 5 PM

- 18F at Noon
- 25F at 4 PM
- 21F at 8 PM

Min RH: 45%

Wind: Northeast 6 to 10 mph.



ENTRIES AND START LISTS



- „ PLEASE check entries
- „ Skiathlon seeding per SuperTour Rules
- „ Start list will be prepared after entries have been checked
- „ Bibs will be available later this afternoon at the Competition Office at Birch Hill (Rikke's Roadhouse – small log cabin)

OFFICIAL TRAINING TIMES



- „ Skiathlon – 4PM-7:30PM Sunday
- „ Sprint – 2PM-8PM Tuesday
- „ Relay – 4:30PM-7:30PM Thursday
- „ 30Km/50Km – 9AM-3PM Saturday
- „ All trails and courses are open all day every day with the exception of competition closures

WAX TESTING



- „ You may test on course (same technique) until course closes 5 minutes prior to the start
- „ No skate testing on classic course
- „ During the race you may continue to test glide on the West Ramp – you will be shown in the stadium presentation
- „ Classic Testing for the Men’s Race – will be permitted on the course after the women have finished their classic leg. Listen for the PA announcement. Access the course through the Terrain Garden, NOT through the infield

PREPARATION OF THE COURSE



- „ Equipment Used
- „ Grooming Time Schedule
- „ Course Markings In Place

COURSE INFORMATION

Bill Husby, Chief of Course

Tom Helmers, Head
Groomer

- „ Map
 - „ Profile
 - „ Course Markings
 - „ Intermediate Timing Points
 - „ Feeding Locations
 - „ Course closure during competition
- 
- A decorative graphic consisting of several parallel white lines of varying lengths, slanted diagonally from the bottom right towards the top right, located in the lower right quadrant of the slide.

**NORDIC
SKI CLUB**



FAIRBANKS

web: www.nscfairbanks.org

Nordic Ski Club
of Fairbanks
101 Wilderness Dr.
Fairbanks, AK
99712



Doyon Utilities Distance National Championships & Super Tour Finals

presented by Advanced Physical Therapy
and L. L. Bean

organized by Nordic Ski Club of Fairbanks
<http://supertourfinals2017fairbanks.us/>

Skiathlon - Monday, March 27

Jim Whisenant Ski Trails

Birch Hill Recreation Area, Fairbanks, Alaska

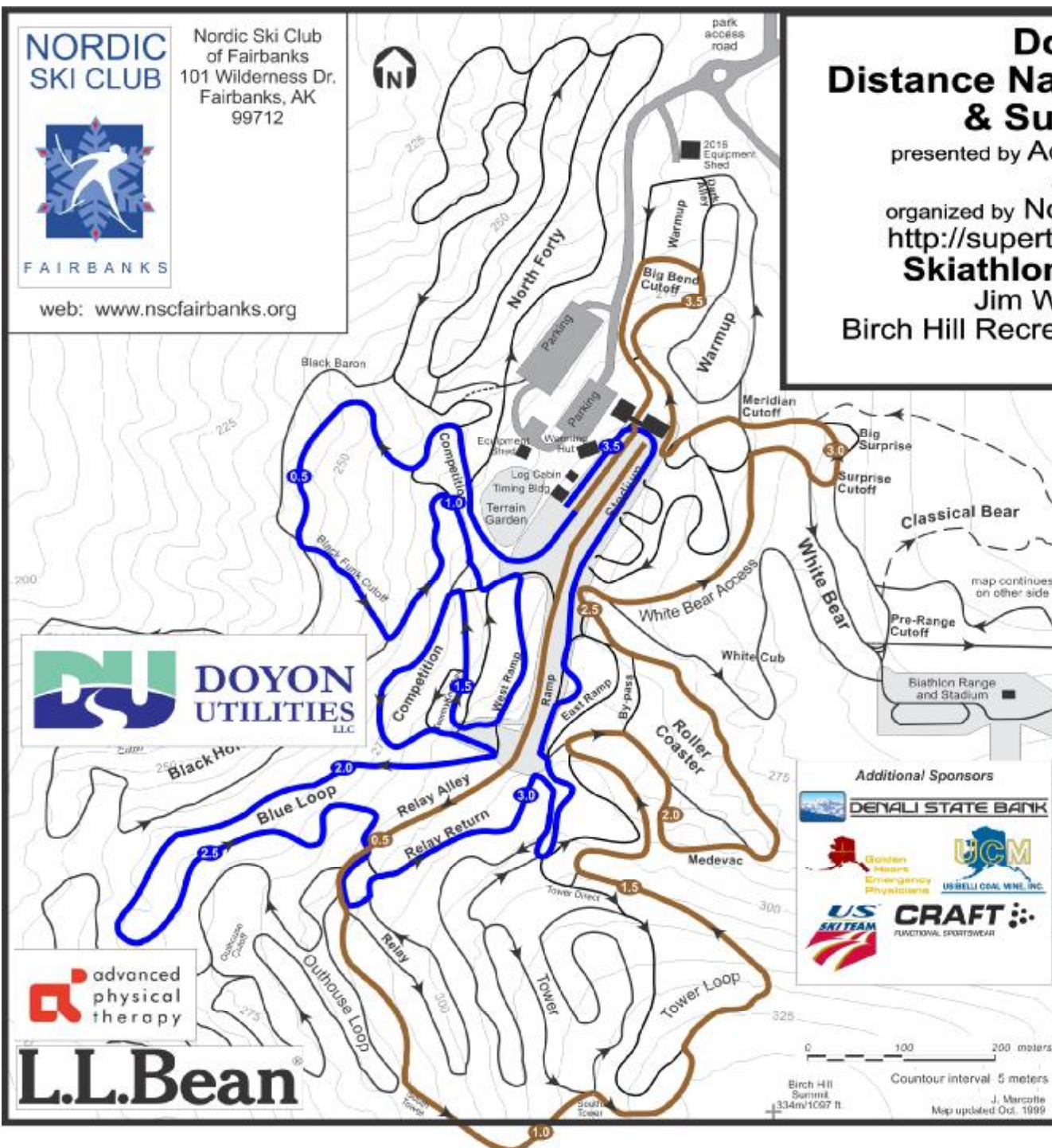

Women 7.5Km CI + 7.5Km Fr
2 laps A + 2 laps B
Junior Women 7.5Km CI (2 laps A)

Men 11.25Km CI + 11.25Km Fr
3 laps A + 3 laps B
Junior Men 11.25Km CI (3 laps A)

**Technical Information
for
South Tower 3.75Km A
(Brown Course):**

Height Difference (HD): 72m
Maximum Climb (MC): 38m
Total Climb (TC): 126m
Measured Length: 3858m
Climb per Km: 32.7m/km

**Technical Information
for
Black Funk 3.75Km B
(Blue Course):**

Height Difference (HD): 66m
Maximum Climb (MC): 48m
Total Climb (TC): 133m
Measured Length: 3822m
Climb per Km: 34.8m/km

Additional Sponsors



0 100 200 meters
Countour interval 5 meters
Birch Hill Summit 334m/1097 ft
J. Marcotte
Map updated Oct. 1999



L.L.Bean

Birch Hill Cross Country Ski Stadium and Environs

Super Tour Finals Skiathlon

Monday, March 27, 2017

Key	
Permanent Steel Fence	V-board
Split-Rail Fence	Competitor Access to Start/From Finish
Portable Fence	Spectator Access
Classic Course	
Skate Course	



Birch Hill Cross Country Ski Stadium and Environs SuperTrour Finals Skiathlon

Women **7.5C**+**7.5F**; Men **11.25C**+**11.25F** - Monday, March 27, 2017

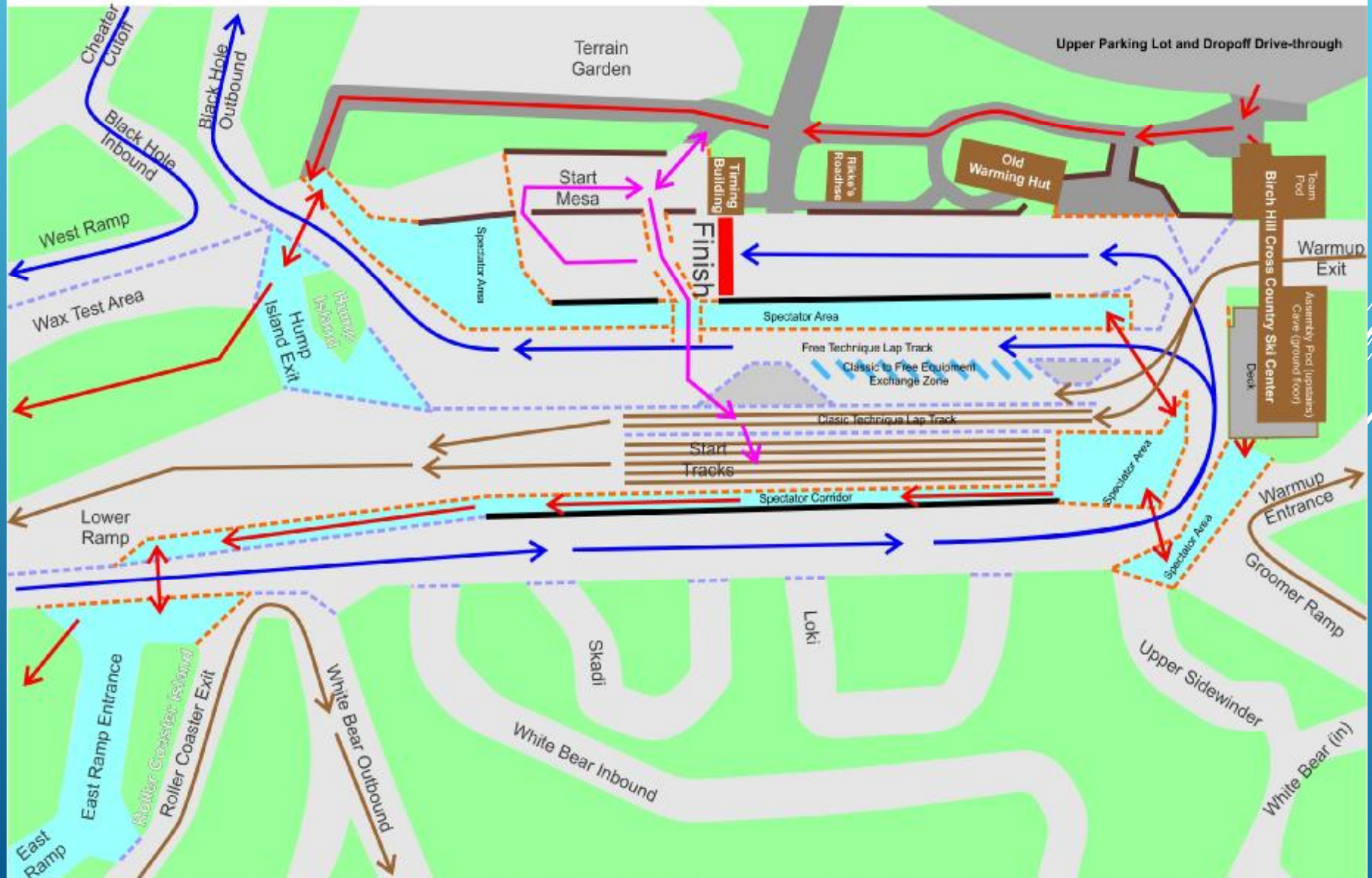
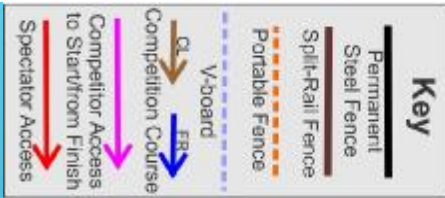

DESCRIPTION OF STADIUM



- „ Location of Start
- „ Athlete Access to the Start
- „ Coach Access to the Start Area
- „ Application of Timing Chips
- „ Clothing Service
- „ Pole Measurement for Classic Events
- „ Ski Exchange Zone for Skiathlon
- „ Relay Exchange Zone
- „ Location of Finish / Banners / FinishLynx
- „ Coach Access to the Finish Area with RED bib only
- „ No Coaching Areas
- „ Feed Zones

POST FINISH SERVICES



- „ Post-Race Athlete Services
- „ Chip Removal
- „ Bib Retrieval (Monday and Wednesday only)
- „ Clothing Service
- „ Refreshments
- „ Exit Post-Finish Area

CONDUCT OF
ATHLETES, COACHES
AND SERVICE PEOPLE
ON THE COURSE
DURING COMPETITION

- „ *BEGINNING 2 HOURS PRIOR TO THE START:*
Access to Course depends upon wearing a competitor bib, GREEN or RED coach bib or service bib
- „ Bib must be worn as outermost layer of clothing
- „ Movement on course by coaches during the competition only as specified by the Technical Delegate and Jury
- „ Warming up and/or testing on course by athletes during the competition only as specified by the Technical Delegate and Jury
- „ Start/Finish Bibs – Red bibs allow access to Start and Finish Areas AND to course – one red bib per team



MONDAY TIMELINE



- „ 1505 – Training Opens – Be sure to wear a bib
- „ 1655 – Courses closed
- „ 1700 – Women Skiathlon Start & Junior Classic Start
ONLY competitors and coaches with bibs on course
- „ 1720 (approx) – Classic course open to male skiers with bibs for wax-testing & warmup;
WAIT FOR PA ANNOUNCEMENT
- „ 1755 – Women’s Awards Ceremony in stadium
- „ 1810 – Courses Closed for Men’s Race
- „ 1815 – Men Skiathlon Start & Junior Classic Start
ONLY competitors and coaches with bibs on course
- „ 1930 – Men’s Awards Ceremony in stadium

GENERAL
INFORMATION FROM
TECHNICAL DELEGATE
ALLAN SERRANO



- „ Jury Members will be on Start Mesa to perform random pole height checks
- „ Skis must be placed in exchange boxes not later than 5 minutes prior to the start
- „ Overtaking in exchange area on LEFT ONLY
- „ Lapped skiers will NOT be pulled, but they must yield to faster skiers
- „ There will be multiple teams of technique controllers on the classic course

INFORMATION
FROM
ASSISTANT TD
JEFF ELLIS



„ WHATSAPP?

GENERAL
INFORMATION:
USSA REPRESENTATIVES
ROBERT LAZZARONE
& BRYAN FISH



- „ Bryan Fish Will Arrive Tonight
- „ Robert Lazzaroni Will Arrive Tuesday night
- „ There will be a meeting for coaches with Bryan and Robert on Thursday following the TCM

GENERAL
INFORMATION FROM
CHIEF OF
COMPETITION JOHN
ESTLE



- „ If you see any problems or issues that the OC needs to deal with please call me first – 907-347-1061. Please give us a chance to solve the problem
- „ Timing
 - „ Chip timing for information
 - „ FinishLynx for photofinish
 - „ Backup Manual
- „ Medical
 - „ Nordic Ski Patrol on-site
 - „ FFD EMS/Ambulance on call (911)
 - „ AED on-site

GENERAL
INFORMATION FROM
CHIEF OF
COMPETITION JOHN
ESTLE



- „ Awards –
- „ Awards for Skiathlon, Sprint, Relay and 30K/50K will be presented immediately following each competition. Overall SuperTour awards will be presented at the Athlete Party Sunday night.
- „ Skiathlon Awards:
 - „ Women at 5:55PM
 - „ Junior Women
 - „ 1st 6 overall – flowers and checks
 - „ 1st 6 USSA with medals
 - „ Men at 7:30PM (same order as women)

GENERAL
INFORMATION FROM
CHIEF OF
COMPETITION JOHN
ESTLE



- „ Sprint Schedule – we are working on it. We will have junior heats prior to the senior heats, then a break for course inspection.
- „ RELAY INFO
 - „ Entries requested Wednesday night after the sprint
 - „ Entry deadline is 9AM Thursday
 - „ You may substitute one skier for another, but you may not change the order
- „ Athlete Party Sunday Night at Birch Hill Cross Country Ski Center Building
- „ WE NEED EACH TEAM TO SUBMIT A COUNT of skiers who will be attending the party.

END OF MEETING



- „ Questions?
- „ Next Meeting 12:30PM Tuesday –
Sprint Info
- „ Adjournment